

MS4 Assistance

CEC's stormwater professionals provide assistance to Municipal Separate Storm Sewer Systems (MS4s) with managing stormwater programs and staying in compliance with regulatory permits.

MUNICIPAL SEPARATE STORM SEWER SYSTEM (MS4)

Paraphrasing Title 40 of the Code of Federal Regulations, an MS4 is a conveyance or system of conveyances owned or operated by a public body and designed or used for collecting or conveying stormwater. An MS4 is not a combined sewer or part of a publicly owned treatment works.

CEC assists municipalities designated as MS4s that are required to develop Pollutant Reduction Plans (PRPs) and comply with federal and state permits to maintain and improve water quality. CEC also works closely with regulatory agencies at the state level to provide technical support and to gain a better understanding of regulation changes.

The experienced experts at CEC stay abreast of the current regulatory requirements and Best Management Practices (BMPs) to maintain compliance with permits and appropriately manage water resources. Services include:

- Stream Restoration and Enhancement
- Basin Retrofit Designs
- Storm Sewer Mapping
- Green Infrastructure Improvements
- Stormwater Best Management Practice (BMP) Design
- Ordinance Review and Preparation
- Benthic Macroinvertebrate Stream Sampling
- Stream Monitoring Work Plan Development
- Corrective Action Plan Development
- Storm Sewer Input Location Mapping
- Annual Report Preparation
- Site Plan Review
- Stormwater User Fee Development Assistance
- Stormwater Base Fee Determination
- Training and Educational Assistance
- Grant Application Preparation for Project Funding

HOW IS AN MS4 PROGRAM FUNDED?

- Using Municipal General Funds
- Federal Funding
- Establishing Special Assessment Districts
- Applying for grants and/or loans
- Creating a Stormwater User Fee (Fixed Rate or Equivalent Residential Unit)



Basin Retrofit



Impaired Reach, Pre-Restoration.



Restored Reach, Post-Restoration.

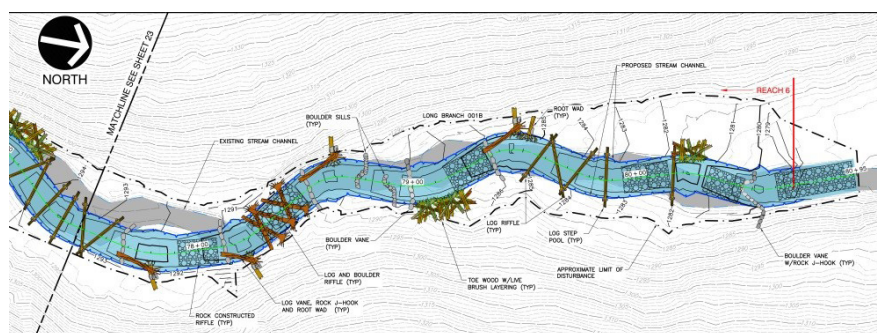

Stream Restoration Design Plan